

September 26, 2017

MEMORANDUM

FROM: Charles Harris, Asst Dean IT/Campus Safety *CH*

TO: College Community

RE: 2017 Campus Safety and Security Survey

Attached to this document you will find our 2016 campus crime report as reported to the U.S. Department of Education for the twelve month period beginning October 1, 2015 – September 30, 2016. The information contained in the report is compiled in accordance with the provisions of the Jeanne Clery Disclosure of Campus Security Policy and Campus Crime Statistics Act and the Violence Against Women Act of 1994 (VAWA). As required by law, this statement and the Campus Safety and Security Survey shall be distributed to all students and employees by October 1, 2017. These documents will also be published to the college website.

This report includes statistics for the previous two years concerning reported crimes that occurred on campus; in certain off-campus buildings or property owned or controlled by Trenholm State Community College; and on public property within, or immediately adjacent to and accessible from either campus. The report is compiled from local college sources and data from the City of Montgomery Police Department for 2016.

Trenholm State Community College properties continues to maintain a good safety posture. As indicated in the attached report, there were seven reportable events committed on or near our campuses. As with previous years, we continue to report theft of college property that meets the reportable guidelines of the Clery Act. By law, and according to the Clery Act Handbook, events are reported regardless of legal interpretations, therefore this report is compiled according to the following statement:

“You must **disclose reported offenses**, not the findings of a court, coroner or jury or the decision of a prosecutor. Classify and count crimes from the records of calls for service, complaints and investigations.”

In this year’s report you will see there has been an uptick in burglary activity within the college and also in areas around the college.

The most significant criminal activity within the college was a purse snatching that occurred on the Trenholm campus on October 22, 2015, an arson event where local juveniles set a fire to one of our training vehicles on the Patterson campus previously used in the auto service program on June 12, 2016, and the theft of four welding machines from our welding shop on June 22, 2016.

The college has continued to enhance the presence of security guards on the Patterson and Trenholm campuses by extending security services to 24 hours per day and 18 hours per day at the library. A new security contract was extended to DSI Security Services on September 18, 2017. On the Patterson campus a new surveillance camera expansion project was completed to significantly expand the system. As a result, a number of events have been captured on video and used as evidence that would have previously not been possible. The Patterson renovation project has also resulted in significant improvements lighting, parking, and general safety of the property. The lighting around the Library has also been greatly improved. An upgraded high resolution surveillance system is programmed to be completed in the Library by October 31, 2017. When completed, the entire college enterprise will have more than 100 high resolution internal and external cameras to monitor activity throughout the college.

The College is required to provide a system to notify you of emergency and non-emergency events. The responsibility to initiate those notifications rest with the Office of Information Technology and Campus Safety. One or all three systems may be used to provide these notifications in time to be useful. Those systems are hereby known as, Trenholm Alert, Alertus, and the Alert Notification System. Depending on the event, some systems will not be used as an added measure of safety. The systems will never be used for general messages, however will be used for practice drills.

Trenholm Alert – Subscriber based system that provides SMS text messages to your mobile phone, text to speech messages to phone numbers you choose to be contacted, and email. More information about this system can be found at <http://www.trenholmstate.edu/college-info/tstc-trenholm-alert.cms>. The system is also integrated with the college Twitter account and Alertus below.

Alertus - An electronic system, tightly integrated into Trenholm Alert. Not specifically for students, however messages received by employees will affect your behavior and actions in an emergency.

Alert Notification System - Radio based loud speaker system containing canned messages. Can be considered a giant voice or intercom type system reaching the entire college. Will be used to notify you of severe weather and building evacuations.

Providing a safe environment for learning is the responsibility of every employee. It is through your continued vigilance and zero tolerance for disruptions to college business that enables the college maintain its strong safety posture.

Attachments:

1. 2016 Campus Safety and Security Survey
2. 2016 City of Montgomery Crime Statistics for On and Off Campus Sites

2017 Campus Safety and Security Survey

Institution: Main Campus - Trenholm Campus (102313001)

User ID: C1023131

Screening Questions

Please answer these questions carefully. The answers you provide will determine which screens you will be asked to complete for this data collection.

1. Does your institution provide On-campus Student Housing Facilities?

No.

Yes. (If Yes is selected, you must enter the number of student housing facilities below and enter Fire Statistics for each facility.)

Number of On-campus Student Housing Facilities:

2. Does your institution have any noncampus buildings or properties?

Yes

No

3. Have you combined statistics that you received from the local or state police with your institution statistics for this report? If you answer No to this question, you will be asked to provide the data you received from the local and state police separately.

Yes. Local and/or state law enforcement agencies provided us with statistics that we are combining with statistics collected by our campus security authorities.

No. We are not combining the statistics because we cannot determine whether the statistics we obtained from local and/or state law enforcement agencies are for on-campus incidents or public property incidents.

Not available. We cannot determine if the statistics we obtained from local and/or state law enforcement agencies are for our Clery geography.

Not available. We made a good-faith effort to obtain statistics from local and/or state law enforcement agencies, but the agencies did not comply with our request.

Criminal Offenses - On campus

For each of the following criminal offenses, enter the number reported to have occurred On Campus.

Criminal offense	Total occurrences On campus		
	2014	2015	2016
a. <u>Murder/Non-negligent manslaughter</u>	0	0	0
b. <u>Negligent manslaughter</u>	0	0	0
c. <u>Rape</u>	0	0	0
d. <u>Fondling</u>	0	0	0
e. <u>Incest</u>	0	0	0
f. <u>Statutory rape</u>	0	0	0
g. <u>Robbery</u>	0	0	1
h. <u>Aggravated assault</u>	0	0	0
i. <u>Burglary</u>	2	3	6
j. <u>Motor vehicle theft</u> (Do not include theft from a motor vehicle)	0	0	0
k. <u>Arson</u>	0	0	1

Caveat:

If you have changed prior years' data, you must add a caveat explaining the change. Use the following format: "For (YEAR), Line (X) was changed from (A) to (B) because (REASON)."

Criminal Offenses - Noncampus

For each of the following criminal offenses, enter the number reported to have occurred in or on Noncampus buildings or property.

Criminal offense	Total occurrences in or on Noncampus buildings or property		
	2014	2015	2016
a. <u>Murder/Non-negligent manslaughter</u>	0	0	0
b. <u>Negligent manslaughter</u>	0	0	0
c. <u>Rape</u>	0	0	0
d. <u>Fondling</u>	0	0	0
e. <u>Incest</u>	0	0	0
f. <u>Statutory rape</u>	0	0	0
g. <u>Robbery</u>	0	0	0
h. <u>Aggravated assault</u>	0	0	0
i. <u>Burglary</u>	0	0	0
j. <u>Motor vehicle theft</u> (Do not include theft from a motor vehicle)	0	0	0
k. <u>Arson</u>	0	0	0

Caveat:
If you have changed prior years' data, you must add a caveat explaining the change. Use the following format: "For (YEAR), Line (X) was changed from (A) to (B) because (REASON)."

Criminal Offenses - Public Property

For each of the following criminal offenses, enter the number reported to have occurred on Public Property.

Criminal offense	Total occurrences on Public Property		
	2014	2015	2016
a. <u>Murder/Non-negligent manslaughter</u>	0	0	0
b. <u>Negligent manslaughter</u>	0	0	0
c. <u>Rape</u>	0	0	0
d. <u>Fondling</u>	0	0	0
e. <u>Incest</u>	0	0	0
f. <u>Statutory rape</u>	0	0	0
g. <u>Robbery</u>	0	0	0
h. <u>Aggravated assault</u>	0	0	0
i. <u>Burglary</u>	0	0	0
j. <u>Motor vehicle theft</u> (Do not include theft from a motor vehicle)	0	0	1
k. <u>Arson</u>	0	0	0

Caveat:

If you have changed prior years' data, you must add a caveat explaining the change. Use the following format: "For (YEAR), Line (X) was changed from (A) to (B) because (REASON)."

i. <u>Burglary</u>	0	0	0	0	0	0	0	0	0
j. <u>Motor vehicle theft</u>	0	0	0	0	0	0	0	0	0
k. <u>Arson</u>	0	0	0	0	0	0	0	0	0
l. <u>Simple assault</u>	0	0	0	0	0	0	0	0	0
m. <u>Larceny-theft</u>	0	0	0	0	0	0	0	0	0
n. <u>Intimidation</u>	0	0	0	0	0	0	0	0	0
o. <u>Destruction/damage/ vandalism of property</u>	0	0	0	0	0	0	0	0	0

Caveat:

If you have changed prior years' data, you must add a caveat explaining the change. Use the following format:
 "For (YEAR), Line (X) was changed from (A) to (B) because (REASON)."

i. <u>Burglary</u>	0	0	0	0	0	0	0	0	0
j. <u>Motor vehicle theft</u>	0	0	0	0	0	0	0	0	0
k. <u>Arson</u>	0	0	0	0	0	0	0	0	0
l. <u>Simple assault</u>	0	0	0	0	0	0	0	0	0
m. <u>Larceny-theft</u>	0	0	0	0	0	0	0	0	0
n. <u>Intimidation</u>	0	0	0	0	0	0	0	0	0
o. <u>Destruction/damage/ vandalism of property</u>	0	0	0	0	0	0	0	0	0

Caveat:

If you have changed prior years' data, you must add a caveat explaining the change. Use the following format: "For (YEAR), Line (X) was changed from (A) to (B) because (REASON)."

h. <u>Aggravated assault</u>	0	0	0	0	0	0	0	0	0
i. <u>Burglary</u>	0	0	0	0	0	0	0	0	0
j. <u>Motor vehicle theft</u>	0	0	0	0	0	0	0	0	0
k. <u>Arson</u>	0	0	0	0	0	0	0	0	0
l. <u>Simple assault</u>	0	0	0	0	0	0	0	0	0
m. <u>Larceny-theft</u>	0	0	0	0	0	0	0	0	0
n. <u>Intimidation</u>	0	0	0	0	0	0	0	0	0
o. <u>Destruction/damage/ vandalism of property</u>	0	0	0	0	0	0	0	0	0

Caveat:

If you have changed prior years' data, you must add a caveat explaining the change. Use the following format: "For (YEAR), Line (X) was changed from (A) to (B) because (REASON)."

VAWA Offenses - On Campus

For each of the following crimes, enter the number reported to have occurred On Campus.

Crime	Total occurrences On Campus		
	2014	2015	2016
a. <u>Domestic violence</u>	0	0	0
b. <u>Dating violence</u>	0	0	0
c. <u>Stalking</u>	0	0	0

Caveat:
If you have changed prior years' data, you must add a caveat explaining the change. Use the following format: "For (YEAR), Line (X) was changed from (A) to (B) because (REASON)."

VAWA Offenses - Noncampus

For each of the following crimes, enter the number reported to have occurred in or on Noncampus buildings or property.			
Crime	Total occurrences in or on Noncampus buildings or property		
	2014	2015	2016
a. <u>Domestic violence</u>	0	0	0
b. <u>Dating violence</u>	0	0	0
c. <u>Stalking</u>	0	0	0

Caveat:

If you have changed prior years' data, you must add a caveat explaining the change. Use the following format: "For (YEAR), Line (X) was changed from (A) to (B) because (REASON)."

VAWA Offenses - Public Property

For each of the following crimes, enter the number reported to have occurred on Public Property.

Crime	Total occurrences on Public Property		
	2014	2015	2016
a. <u>Domestic violence</u>	0	0	0
b. <u>Dating violence</u>	0	0	0
c. <u>Stalking</u>	0	0	0

Caveat:
If you have changed prior years' data, you must add a caveat explaining the change. Use the following format: "For (YEAR), Line (X) was changed from (A) to (B) because (REASON)."

Arrests - On campus

Enter the number of Arrests for each of the following crimes that occurred On Campus.

Do NOT include drunkenness or driving under the influence in Liquor law violations.

Crime	Number of Arrests		
	2014	2015	2016
a. <u>Weapons: carrying, possessing, etc.</u>	0	0	0
b. <u>Drug abuse violations</u>	0	0	0
c. <u>Liquor law violations</u>	0	0	0

Caveat:

If you have changed prior years' data, you must add a caveat explaining the change. Use the following format: "For (YEAR), Line (X) was changed from (A) to (B) because (REASON)."

Arrests - Noncampus

Enter the number of Arrests for each of the following crimes that occurred in or on Noncampus buildings or property.

Do NOT include drunkenness or driving under the influence in Liquor law violations.

Crime	Number of Arrests		
	2014	2015	2016
a. <u>Weapons: carrying, possessing, etc.</u>	0	0	0
b. <u>Drug abuse violations</u>	0	0	0
c. <u>Liquor law violations</u>	0	0	0

Caveat:

If you have changed prior years' data, you must add a caveat explaining the change. Use the following format: "For (YEAR), Line (X) was changed from (A) to (B) because (REASON)."

Arrests - Public Property

Enter the number of Arrests for each of the following crimes that occurred on Public Property.

Do NOT include drunkenness or driving under the influence in Liquor law violations.

Crime	Number of Arrests		
	2014	2015	2016
a. <u>Weapons: carrying, possessing, etc.</u>	0	0	0
b. <u>Drug abuse violations</u>	0	0	0
c. <u>Liquor law violations</u>	0	0	0

Caveat:

If you have changed prior years' data, you must add a caveat explaining the change. Use the following format: "For (YEAR), Line (X) was changed from (A) to (B) because (REASON)."

Disciplinary Actions - On Campus

Enter the number of persons referred for disciplinary action for crimes that occurred On Campus for each of the following categories.

Do not include disciplinary actions that were strictly for school policy violations.

If the disciplinary action is the result of an arrest, please do not count it here; count the violation as 1 arrest.

Do NOT include drunkenness or driving under the influence in Liquor law violations.

Crime	Number of persons referred for Disciplinary Action		
	2014	2015	2016
a. <u>Weapons: carrying, possessing, etc.</u>	0	0	0
b. <u>Drug abuse violations</u>	0	0	0
c. <u>Liquor law violations</u>	0	0	0

Caveat:

If you have changed prior years' data, you must add a caveat explaining the change. Use the following format: "For (YEAR), Line (X) was changed from (A) to (B) because (REASON)."

Disciplinary Actions - Noncampus

Enter the number of persons referred for disciplinary action for crimes that occurred in or on Noncampus buildings or property for each of the following categories.

Do not include disciplinary actions that were strictly for school policy violations.

If the disciplinary action is the result of an arrest, please do not count it here; count the violation as 1 arrest.

Do NOT include drunkenness or driving under the influence in Liquor law violations.

Crime	Number of persons referred for Disciplinary Action		
	2014	2015	2016
a. <u>Weapons: carrying, possessing, etc.</u>	0	0	0
b. <u>Drug abuse violations</u>	0	0	0
c. <u>Liquor law violations</u>	0	0	0

Caveat:

If you have changed prior years' data, you must add a caveat explaining the change. Use the following format: "For (YEAR), Line (X) was changed from (A) to (B) because (REASON)."

Disciplinary Actions - Public Property

Enter the number of persons referred for disciplinary action for crimes that occurred on Public Property for each of the following categories.

Do not include disciplinary actions that were strictly for school policy violations.

If the disciplinary action is the result of an arrest, please do not count it here; count the violation as 1 arrest.

Do NOT include drunkenness or driving under the influence in Liquor law violations.

Crime	Number of persons referred for Disciplinary Action		
	2014	2015	2016
a. <u>Weapons: carrying, possessing, etc.</u>	0	0	0
b. <u>Drug abuse violations</u>	0	0	0
c. <u>Liquor law violations</u>	0	0	0

Caveat:

If you have changed prior years' data, you must add a caveat explaining the change. Use the following format: "For (YEAR), Line (X) was changed from (A) to (B) because (REASON)."

Unfounded Crimes

Of those crimes that occurred On Campus, in On-campus Student Housing Facilities, on or in Noncampus property or buildings, and on Public Property, enter the number of crimes that were unfounded.

The total number of unfounded crimes should include all criminal offenses, hate crimes, domestic violence, dating violence, or stalking incidents that have been unfounded. Arrests and disciplinary actions cannot be unfounded.

If a reported crime is investigated by law enforcement authorities and found to be false or baseless, the crime is "unfounded". Only sworn or commissioned law enforcement personnel may unfound a crime.

Count unfounded crimes in the year in which they were originally reported.

	Number		
	2014	2015	2016
a. <u>Total unfounded crimes</u>	0	0	0

Caveat:

If you have changed prior years' data, you must add a caveat explaining the change. Use the following format: "For (YEAR), Line (X) was changed from (A) to (B) because (REASON)."

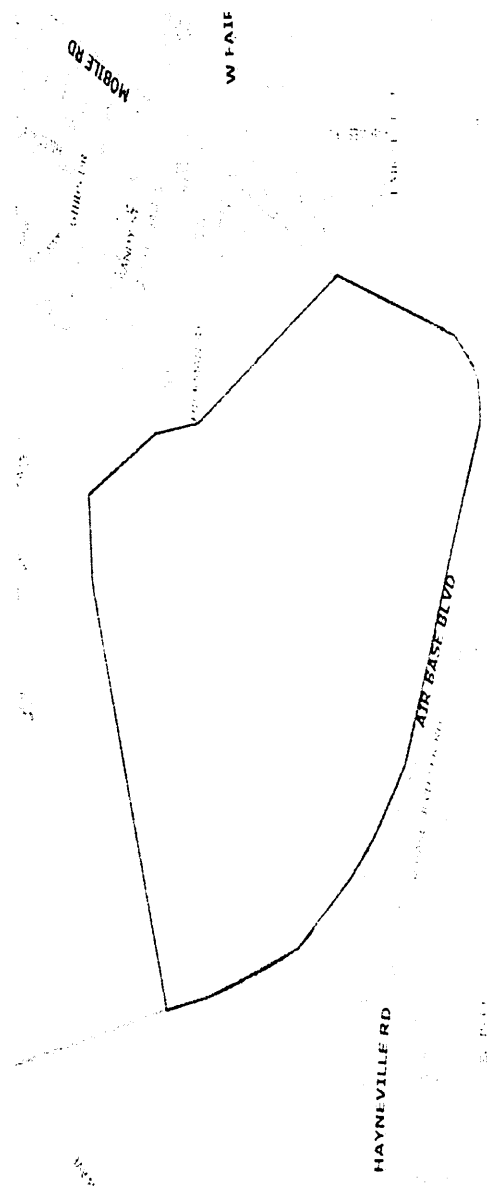

Reporting District	Reported Date	Case Number	Statute	Statute Description	Address	Method of Entry	Status
13	5/1/2016 12:35	2016-00086191	13A-07-006:2203	Burglary 2nd - Non-Residence - Force	3000 MOBILE HWY	No Force	Closed
13	6/19/2016 19:35	2016-00124399	13A-07-007:2203	Burglary 3rd - Non-Residence - Force	1225 AIR BASE BLVD	Forcible	Inactive
13	5/18/2016 15:01	2016-00098760	13A-07-023:2999	Criminal Mischief 3rd - Other	1225 AIR BASE BLVD		Pending
13	10/22/2015 18:26	2015-00211110	13A-08-003:2302	Theft 1st - Purse snatching - no force	1225 AIR BASE BLVD		Inactive
13	7/7/2016 17:02	2016-00138618	13A-08-005:2307	Theft 4th - Coin Operated Machine	1225 AIR BASE BLVD		Closed
13	7/22/2016 11:13	2016-00149397	13A-08-011(B):2305	UBEV/Articles from inside Vehicle	3000 MOBILE HWY		Pending

Reporting District	Reported Date	Case Number	From Date	Through Date	Statute	Statute Description	Address	Method of Entry	Status
18	6/22/2016 15:33	2016-00126588	6/21/2016 16:00	6/22/2016 15:33	13A-07-007 2205	Burglary 3rd - Non-Residence - No Force	3920 TROY HWY	No Force	Pending
18	7/23/2016 16:49	2016-00150512	7/23/2016 18:30	7/23/2016 18:30	13A-07-007 2203	Burglary 3rd - Non-Residence - Force	00 TECHNOLOGY CT	Forceful	Inactive
18	7/24/2016 15:58	2016-00151130	7/24/2016 11:00	7/24/2016 15:50	13A-07-007 2203	Burglary 3rd - Non-Residence - Force	00 TECHNOLOGY CT	Forceful	Inactive
18	7/27/2016 8:07	2016-00153144	7/26/2016 17:00	7/27/2016 8:00	13A-07-007 2203	Burglary 3rd - Non-Residence - Force	3920 TROY HWY	Forceful	Inactive
18	7/19/2016 8:23	2016-00147046	7/19/2016 8:00	7/19/2016 8:23	13A-06-122 1324	Domestic Violence 3rd - Cercion/Intimidation	4200 STRATHMORE DR		Pending
18	4/20/2016 12:18	2016-00078049	4/12/2016 8:00	4/20/2016 12:15	13A-11-008(B)(1) 5209	Harassing Communications	3900 TROY HWY	No Force	Pending
18	9/19/2016 15:52	2016-00196918	9/19/2016 11:30	9/19/2016 12:45	13A-06-011(B) 2305	UBEV/Arrests from inside Vehicle	00 TECHNOLOGY CT		Pending

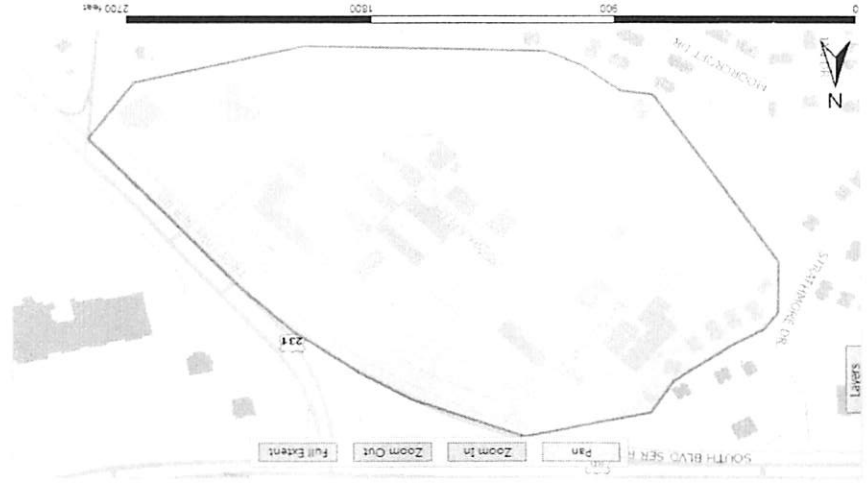

All Addresses are in block ranges except for the actual reports written at the address of the listed School Campus/Site.

Reporting District Reported Date Case Number Statute Statute Description Address Method of Entry Status

Count: 0

0 Cases located

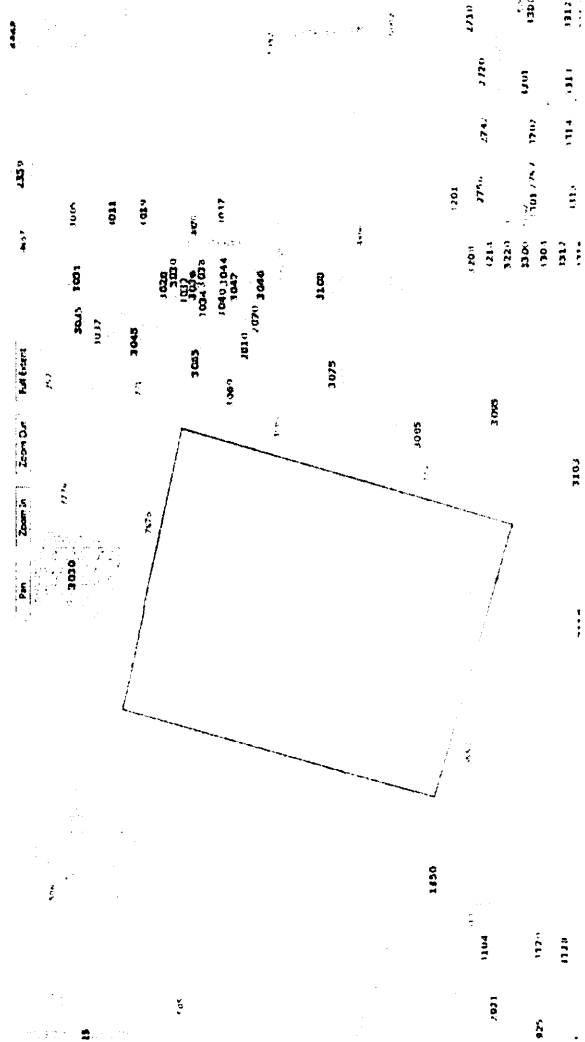

Reporting District	Reported Date	Case Number	Statute	Statute Description	Address	Method of Entry	Status
13	7/22/2016 11:13	2016-00149397	13A-08-01(B).2305	UBEV/Articles from inside Vehicle	3000 MOBILE HWY		Pending

Reporting District

Reported Date

Case Number

Statute

Statute Description

Address

Method of Entry

Status

Count: 0

0 Cases located



Reporting District	Reported Date	Case Number	Statute	Statute Description	Address	Method of Entry	Status
24	10/21/2015 20:48	2015-00210487	13A-06-132:1324	Domestic Violence 3rd - Coercion/Harassment/Intimidation	00 COMMERCE ST		Closed
24	12/20/2015 12:09	2015-00251036	13A-08-011:2411	Unauthorized Use of Vehicle - No Force	00 DEXTER AVE		Pending
24	1/3/2016 12:26	2016-00001686	13A-08-011(B):2305	UBEV/Articles from inside Vehicle	100 MONTGOMERY ST	No Force	Pending
24	2/3/2016 23:17	2016-00024167	13A-07-007:2205	Burglary 3rd - Non-Residence - No Force	00 MONROE ST	No Force	Pending
24	2/9/2016 14:05	2016-00027784	13A-08-011(B):2305	UBEV/Articles from inside Vehicle	100 MONTGOMERY ST		Pending
24	2/17/2016 6:50	2016-00033180	13A-08-04.1:2306	Theft 3rd - From Shipment	00 DEXTER AVE		Pending
1	2/19/2016 10:04	2016-00034771	13A-07-023:2901	Criminal Mischief 3rd - Damage to Business Property	00 COURT SQ		Pending
24	2/19/2016 23:16	2016-00035249	13A-08-011(B):2305	UBEV/Articles from inside Vehicle	00 COMMERCE ST		Pending
24	4/28/2016 15:44	2016-00084064	13A-08-005:2308	Theft 4th - From a Public Building	00 COMMERCE ST		Closed
24	5/14/2016 21:03	2016-00096137	13A-08-003:2404	Theft 1st - Motor Vehicle	00 DEXTER AVE		Pending
24	5/15/2016 3:02	2016-00096316	13A-08-04.1:2308	Theft 3rd - Public Building	00 COMMERCE ST		Pending
24	5/15/2016 9:03	2016-00096424	13A-08-011(B):2305	UBEV/Articles from inside Vehicle	00 COMMERCE ST		Pending